



## Cape to Cape 2016 onboard the *Silver Explorer*

The *Silver Explorer* has been designed specifically for navigating waters in some of the world's most remote destinations, including both polar regions. A strengthened hull with a Lloyd's +100A1+LMC Ice Class rating for passenger vessels allows her to safely push through ice floes with ease. There is plenty of deck space for observing the natural wonders and whenever possible the Captain will maneuver the ship to make the most of wildlife sightings.

### Suite Categories

Owner's Suite	\$28,040
Grand Suite	\$25,340
Silver Suite	\$22,540
Medallion Suite	\$21,140
Expedition Suite	\$18,440
Veranda Suite	\$15,040
Vista Suite	\$13,940
View Suite	\$13,340
Explorer Suite	\$12,440
Adventurer Suite	\$ 11,840
Solo - Vista	\$17,373
Solo - View	\$16,623
Solo - Explorer	\$15,498
Solo - Adventurer	\$14,748

### Suite Rates

### Vessel Specifications

Length.....	354 feet
Width.....	52 feet
Speed.....	14 knots
Tonnage.....	6,072
Ice-class Rating.....	1A
Guests.....	132
Crew.....	113
Refurbished.....	2008
Passenger Decks.....	5
Registry.....	Bahamas

### All Suites Include:

Twin or queen premium mattresses (except suites 512 & 513 which have a fixed queen bed) with a choice of nine pillow types; fine Pratesi bed linens and down duvets; refrigerator and bar stocked with your preferences; iPod docking station; writing table; personal safe; hair dryer; flat screen television with interactive video, on-demand movies and music, and satellite news programming; plush robes and slippers; daily suite service with nightly turndown.



# Expedition Details

## Cape to Cape February 29 – March 23, 2016

**24 Days** Trip Length

**Buenos Aires, Argentina** Start

**Cape Town, South Africa** End

### Included

Included in the price of your Apex expedition are all accommodations as noted in the itinerary; meals, activities and excursions; all gratuities; chartered group flight from Buenos Aires to Ushuaia; complimentary room service onboard the vessel; select wines and premium spirits onboard the vessel; local beer and wine with meals in Buenos Aires; services of six Apex Expeditions leaders, as well as the full onboard lecture team and expedition staff; local guides; airport transfers; permits; entrance fees; and taxes.

### Not Included

Not included in the price of your Apex expedition are airfare to Buenos Aires and home from Cape Town; select premium wines and liquors; travel insurance (Trip Cancellation and Interruption, as well as Emergency Medical and Evacuation insurance are recommended); airport departure taxes; passport, reciprocity and/or visa fees; excess luggage charges; items of a personal nature (phone calls, laundry, souvenirs, etc.); onboard spa and salon services; and independent travel arrangements pre- or post-trip.

### Payments & Terms

25% of the trip cost will confirm your place on the expedition. The final balance is due 150 days prior to departure. All prices are quoted in U.S. dollars and must be paid in U.S. dollars. Per person pricing is based on double occupancy. The Solo Rate is paid by participants who specifically request single accommodations and is subject to availability. If you are traveling alone and wish to share accommodations, we will try to match you with a roommate of the same gender. However, if a roommate is not available, the published Solo Rate will be charged. Upon confirming your reservation you will be required to pay the published Solo Rate, if we are able to pair you with a roommate, the applicable difference will be refunded at the time that final trip payment is due for all participants. Please note that solo accommodations are limited and cannot always be guaranteed throughout. For our full set of Terms & Conditions, please visit our web site at [www.apex-expeditions.com](http://www.apex-expeditions.com).

*One-of-a-kind adventures to the world's most fascinating places. Join us.*



Tristan Albatross © Gary Krosin



# Deck Plan - Silver Explorer

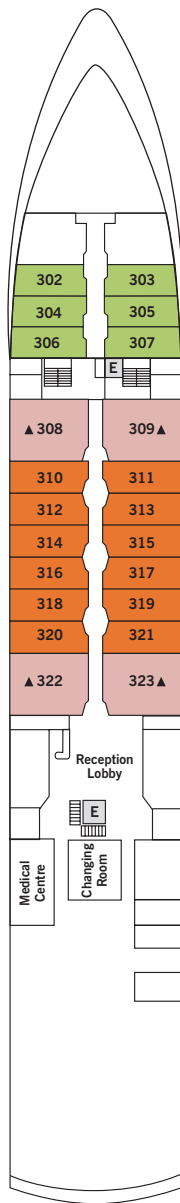

**DECK 3**  
 Reception  
 Medical Center  
 Changing Room  
 Expedition Office

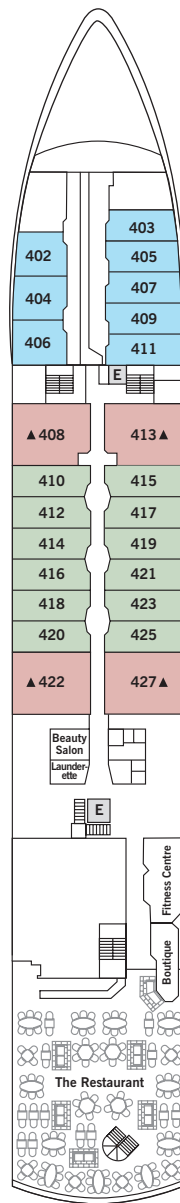

**DECK 4**  
 Salon  
 Boutique  
 Fitness Center  
 Dining Room

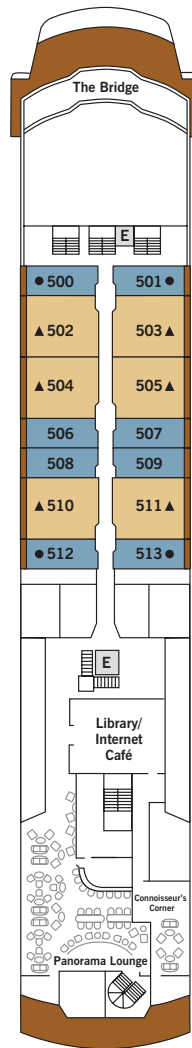

**DECK 5**  
 The Bridge  
 Library / Internet Café  
 Connoisseur's Corner  
 Panorama Lounge

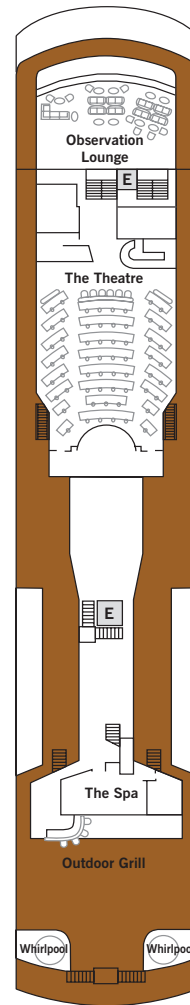

**DECK 6**  
 Observation Lounge  
 The Theater  
 The Spa  
 Outdoor Grill

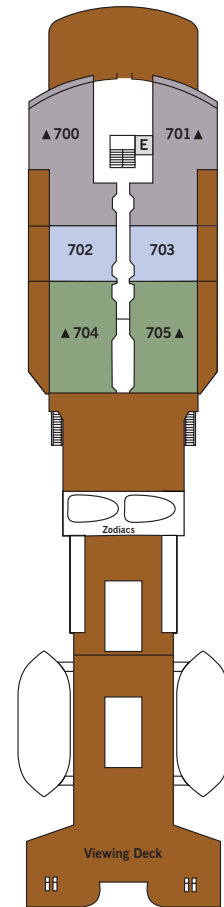

**DECK 7**  
 Viewing Deck

- Adventurer Suite
- View Suite
- Expedition Suite

- Explorer Suite
- Vista Suite
- Expedition Suite

- Veranda Suite
- Silver Suite

- Medallion Suite
- Grand Suite
- Owner's Suite



# Suite Details - *Silver Explorer*

## Owner's Suite



728 sq. ft., including private balcony (158 sq. ft.) • Teak-style balcony with patio furniture and floor-to-ceiling glass doors  
• Living room with sitting area • Marble bathroom, with full-sized bath and separate shower • Walk-in wardrobe • Vanity table  
• Second flat-screen television • Illy espresso maker • Four hours of Internet service per suite • Two hours of worldwide phone use from your suite

## Suite Layout

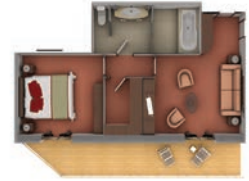

## Grand Suite



618 sq. ft., including private balcony (86 sq. ft.) • Teak-style balcony with patio furniture and floor-to-ceiling glass doors  
• Living room with sitting area • Marble bathroom, with full-sized bath and separate shower • Walk-in wardrobe • Vanity table  
• Second flat-screen television • Illy espresso maker • Four hours of Internet service per suite • Two hours of worldwide phone use from your suite



## Silver Suite



422 sq. ft., including two French Balconies (30 sq. ft.)  
• Two French balconies with floor-to-ceiling glass doors  
• Living room • Marble bathroom, with full-sized bath and separate shower • Walk-in wardrobe • Vanity table • Wifi available (fees apply)



## Medallion Suite



400 sq. ft., including private balcony (86 sq. ft.) • Teak-style balcony with patio furniture and floor-to-ceiling glass doors  
• Sitting area • Marble bathroom, with full-sized bath and separate shower • Wifi available (fees apply)



## Expedition Suite



388-397 sq. ft. • Two view windows on Deck 3 (31.5 in. x 31.5 in.) or two large picture windows on Deck 4 (47 in. x 43 in.) • Living room  
• Marble bathroom, with full-sized bath and separate shower  
• Walk-in wardrobe • Vanity table • Wifi available (fees apply)





### Veranda Suite



- 206-216 sq. ft, including French Balcony (16 sq. ft.) • French balcony with floor-to-ceiling glass doors • Sitting area
- Marble bathroom with tub/shower combination
  - Wifi available (fees apply)

### Suite Layout



### Vista Suite



- 192 sq. ft. • Large picture window providing panoramic ocean views ( 47 in. x 43 in.) • Sitting area • Marble bathroom with tub/shower combination • Wifi available (fees apply)



### View Suite



- 192 sq. ft. • View window (31.5 in. x 31.5 in.) • Sitting area
- Marble bathroom with tub/shower combination
  - Wifi Available (fees apply)



### Explorer Suite



- 175-190 sq. ft. • View window (31.5 in. x 31.5 in.) • Sitting area
- Marble bathroom with tub/shower combination
  - Wifi available (fees apply)



### Adventurer Suite



- 157-167 sq. ft. • Two portholes (15.75 in. diameter) • Sitting area
- Marble bathroom with tub/shower combination
  - Wifi available (fees apply)



*Explorer Suite Pictured Above*

*Suite diagrams and deck plans are for illustration purposes only.*

